

# Technical data sheet

Internal corner, asymmetrical, for device installation trunking Rapid 80 type GS-A70130

Item number: 6277440



Internal corner for direct installation on GS device installation trunking.

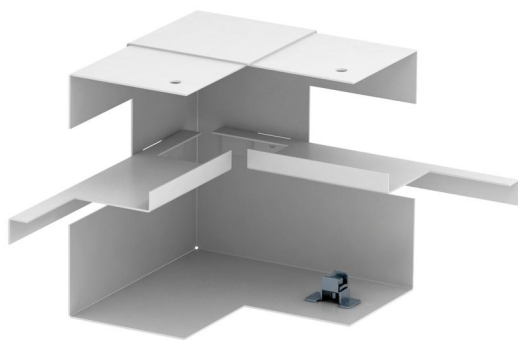

St Steel

## Master data

Item number	6277440
Type	GS-AI70130RW
Description 1	Internal corner
Description 2	simple, asymmetrical
Manufacturer	OBO
Dimension	70x130x128
Colour	Pure white; RAL 9010
Material	Steel
Smallest sales unit	1
Unit of quantity	Piece
Weight	57 kg
Weight unit	kg/100 pc.

# Technical data sheet

Internal corner, asymmetrical, for device installation trunking Rapid 80 type GS-A70130

Item number: 6277440



## Dimensions

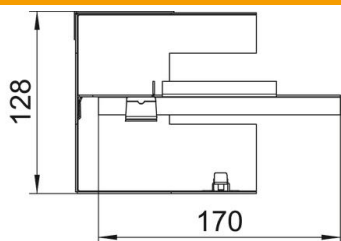

Length	128 mm
Width	130 mm
Height	70 mm

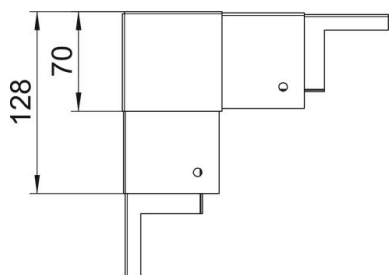

## Technical data

Number of covers	1
Version for	Base
Shape	Asymmetrical
Halogen-free	yes
Cable retaining clip	no
Duct connector	no
Cover mounting type	Internal
Mounting perforation in base	yes
Cover width	76.5 mm
Protection rating	IP30
Protective film	yes
Protection rating IK code	IK10
Permitted temperature range, max.	60 °C
Permitted temperature range, min.	-25 °C
Angle range, min.	90 mm