

# Technical data sheet

## Add-on tee 60 FT

Item number: 6225870



Mounting/branch with welded rung for use in the cable ladder types with a side height of 60 mm.  
Connectors should be ordered separately and in the appropriate quantity.

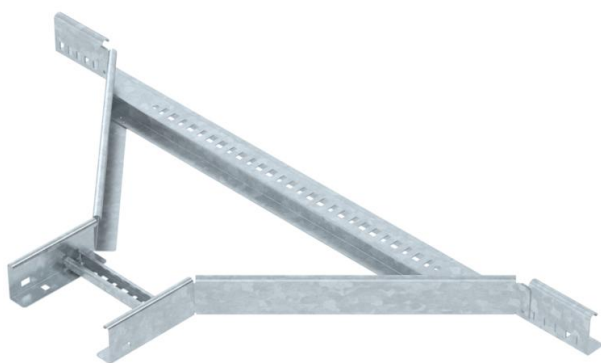

CE

St Steel

FT Hot-dip galvanised

### Master data

Item number	6225870
Type	LAA 620 R3 FT
Description 1	Add-on tee
Description 2	for cable ladder
Manufacturer	OBO
Dimension	60x200
Material	Steel
Surface	Hot-dip galvanised
Surface standard	DIN EN ISO 1461
Smallest sales unit	1
Unit of quantity	Piece
Weight	316 kg
Weight unit	kg/100 pc.

# Technical data sheet

## Add-on tee 60 FT

Item number: 6225870



### Dimensions

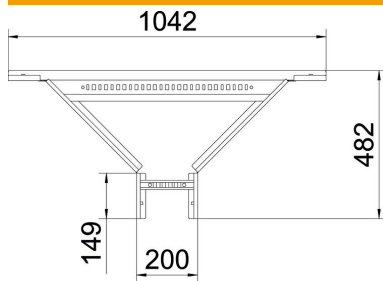

Width	200 mm
Height	60 mm
Dimension B	200 mm
Dimension R	300 mm

### Technical data

Version of the rungs	Profile perforated
Side rail version	Flat profile
Connector version	Without connectors
Maintain electrical functions	no
Rustproof steel, pickled	no
Wide-span version	no
Rail thickness	1.5 mm