

Technical data sheet

Connection plate, L-shaped

Item no. 1124653

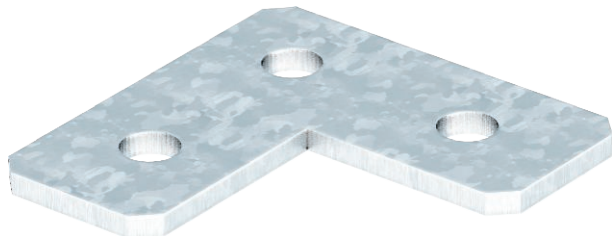

Connection plate with three holes for angled connection of profile rails 41 x 41 mm and 41 x 21 mm.



St	Steel
FT	Hot-dip galvanised

Master data

Item no.	1124653
Type	GMS 3 VP L FT
Description 1	Connection plate
Description 2	L shape
Dimension	90x90x40x5
Material	Steel
Material symbol	St
Surface	Hot-dip galvanised
Surface to DIN	DIN EN ISO 1461
Surface symbol	FT
Smallest sales unit (VG)	10 Piece
Weight	25,00 kg/100 pc.

Technical data

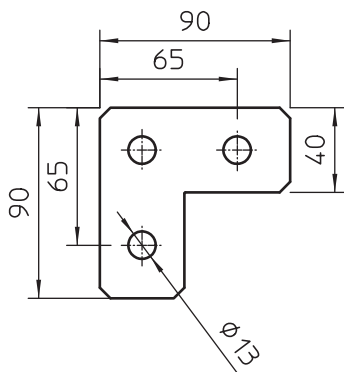

Length	90,00 mm
Width	40,00 mm
Height	5,00 mm
Version	With continuous perforation 13 mm
Version	Bracket
Version	Bracket
Suitable for	C profile
Hole size	13 mm
Material thickness	5,00 mm
With screw accessories	<input type="checkbox"/>
Rustproof steel, pickled	<input type="checkbox"/>